

SPECIAL PURPOSE UNITS

Pilot operated regulators

20AL, 11-400, 11-104 1/4" PTF

Feedback pilot regulators give more sensitive control and quicker reaction to downstream pressure changes.

Feedback 'sensing' line to be kept to minimum length (<200mm).

TECHNICAL DATA

20AL and 11-400

Fluid:

Compressed air filtered to 5µm

Maximum inlet pressure:

360 psig (25 bar)

Operating temperature:

0° to 175°F (-20° to 80°C) *

* Air supply must be dry enough to avoid ice formation at temperatures below 35°F (2°C).

Typical flow: with 100 psig (7 bar) inlet pressure, 23 psig (1.6 bar) set pressure and 1.5 psig (0.1 bar) droop from from set: 4.2 scfm (2 dm³/s)

11-104

Fluid:

Compressed air

Inlet pressure range:

10 psig (0.7 bar) to 400 psig (27.6 bar) maximum

Operating temperature:

0 to 175°F (-20° to 80°C) *

* Air supply must be dry enough to avoid ice formation at temperatures below 35°F (2°C).

Maximum bleed rate at 50 psig (3.5 bar) outlet pressure:

0.25 scfm (0.12 dm³/s)†

†Maximum bleed rate occurs under dead-end (no flow) conditions.



Conventional pilot

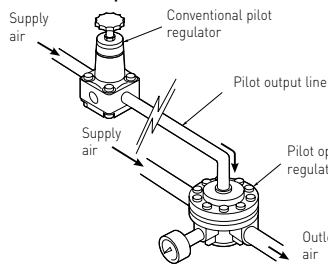

Feedback pilot

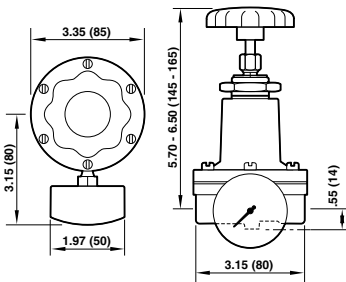
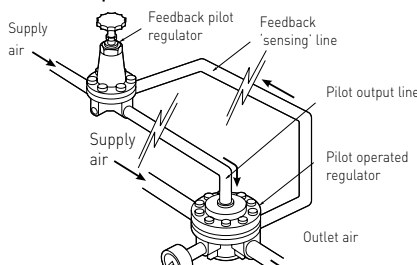

ISO Symbol

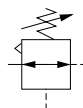

Models – Conventional Pilot Regulators

11-400, 20AL SERIES Model No.	Port size PTF	Outlet pressure adjustment range PSIG (bar)	Operation	Mounting option
-------------------------------	---------------	---	-----------	-----------------



11400-2G/AC103	1/4"	1 to 30 [0.06 to 2]	Relieving	Panel/Bracket
11400-2G/AE103	1/4"	1 to 60 [0.06 to 4]	Relieving	Panel/Bracket
11400-2G/AG103	1/4"	2 to 100 [0.16 to 7]	Relieving	Panel/Bracket
20AL-X2G/AK103	1/4"	100 to 300 [7 to 20]	Relieving	Panel/Bracket

Accessories

Bracket	Gauge kit*	Service
---------	------------	---------



18-001-005	18-013-010	11400-100/20AL
18-001-005	18-013-011	11400-100/20AL
18-001-005	18-013-012	11400-100/20AL
18-001-005	18-013-014	11400-100/20AL

Models – Feedback Pilot Regulators

11-104 SERIES size Model No.	Port size PTF	Outlet pressure adjustment range PSIG (bar)	Operation	Mounting option
------------------------------	---------------	---	-----------	-----------------



11-104-001	1/4"	5 to 105 [0.3 to 7]	Relieving	Panel/Bracket
11-104-002	1/4"	5 to 250 [3 to 17]	Relieving	Panel/Bracket

* Kit includes: Diaphragm assemblies, valve assembly, valve spring O-rings, valve seats for pilots

Bracket	Gauge	
---------	-------	--



18-001-005	18-013-212	1970-11
18-001-005	18-013-205	1970-11

* Kit includes: Diaphragm, valve pit, valve springs, valve seat, valve ball, and all O-rings



Service – Quality – Delivery

NorgrenExpress.com – 1.800.514.0129 – Help@NorgrenExpress.com



ALE-45