

- > **Port size: 3/8" ... 3/4"**  
**(ISO G/NPT)**
- > **Excelon design allows in-line installation or modular installation with other Excelon products**
- > **High efficiency oil and particle removal**
- > **Quick release bayonet bowl**
- > **Service indicator standard**



### Technical features

#### Medium:

Compressed air only

#### Maximum operating pressure:

Transparent bowl:

10 bar (145 psi)

Metal bowl:

17 bar (250 psi)

#### Remaining oil content:

0,01 mg/m<sup>3</sup> at +21°C (69°F)

#### Particle removal:

To 0,01 µm

#### Port size:

G3/8, G1/2, G3/4

3/8 PTF 1/2 PTF , 3/8 PTF

#### Flow:

Maximum flow to maintain stated oil removal performance

F74C: 16 dm<sup>3</sup>/s, F74H 28 dm<sup>3</sup>/s at port size: 1/2"

Operating pressure: 6,3 bar (91 psi)

#### Drain:

Manual, automatic

#### Automatic drain operating conditions (float operated):

Bowl pressure required to close drain: > 0,35 bar (5 psi)

Bowl pressure required to open drain: ≤ 0,2 bar (2.9 psi)

Minimum air flow required to close drain: 1 dm<sup>3</sup>/s (2 scfm)

Manual operation: depress pin inside drain outlet to drain bowl

#### Ambient/Media temperature:

Transparent bowl:

-34 ... +50°C (-29 ... +122°F)

Metal bowl:

-34 ... +65°C (-29 ... +149°F)

Air supply must be dry enough to avoid ice formation at temperatures below +2°C (+35°F).

#### Materials:

Body: Die cast aluminium

Bowl: Transparent PC with steel guard or die cast aluminium



Element: Synthetic fibre & PE foam

Elastomers: CR & NBR

#### Note:

Install an F74G filter with a 5 µm filter element upstream of the F74C/H filter for maximum service life.

### Technical data - standard models

Symbol	Port size	Size	Drain	Bowl with guard	Weight (kg)	Model
	G3/8		Manual	PC (transparent)	0,85	F74C-3GD-QP0
	G1/2	Basic	Manual	PC (transparent)	0,83	F74C-4GD-QP0
	G1/2	Basic	Manual	PC (transparent)	1,11	F74H-4GD-QP0
	G3/4		Manual	PC (transparent)	1,10	F74H-6GD-QP0
	G3/8		Automatic	PC (transparent)	0,85	F74C-3GD-AP0
	G1/2	Basic	Automatic	PC (transparent)	0,83	F74C-4GD-AP0
	G1/2	Basic	Automatic	PC (transparent)	1,11	F74H-4GD-AP0
	G3/4		Automatic	PC (transparent)	1,10	F74H-6GD-AP0

### Option selector

**F74★-★-★-★-★0**

Series	Substitute	Bowl	Substitute
Standard *1)	<b>C</b>	Metal	<b>D</b>
High flow *2)	<b>H</b>	Transparent with guard (standard)	<b>P</b>
Port size	Substitute	Drain	Substitute
3/8"	<b>3</b>	Manual	<b>Q</b>
1/2"	<b>4</b>	Automatic	<b>A</b>
3/4"	<b>6</b>		
Thread form	Substitute		
PTF	<b>A</b>		
ISO G parallel (standard)	<b>G</b>		
Service life indicator	Substitute		
With (visual, standard)	<b>D</b>		
Without	<b>N</b>		

\*1) available with 3/8 or 1/2" ports

\*2) available with 1/2 or 3/4" ports

**Typical performance characteristics**

Inlet pressure (bar)	Maximum flow dm <sup>3</sup> /s*	
	F74C	F74H
1	6,4	11,2
3	11	19,3
5	14,3	24,9
6,3	16	28
7	16,9	29,5
9	19,1	33,5

\* Maximum flow to maintain stated oil removal performance

**Flow characteristics**



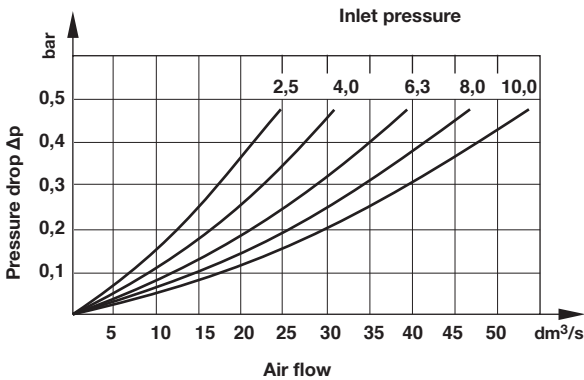

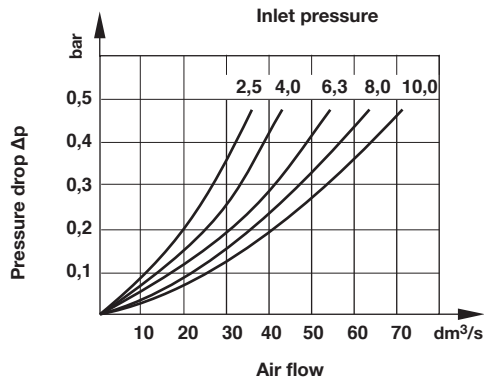

**F74C**  
Port size 1/4"  
Dry element



**F74H**  
Port size 1/4"  
Dry element



**Accessories**

Wall mounting bracket	Quikclamp®	Quikclamp with wall bracket®	Quikmount pipe adaptor *1)	Porting block with three alternative 1/4" ports	2/2 Shut-off valves (for full technical specification see datasheet 8.200.600)	3/2 Shut-off valves (for full technical specification see datasheet 8.200.600)
						
Page 4	Page 3	Page 3	Page 3	Page 3	Page 4	Page 4
4324-50	4314-51	4314-52	G3/8: 4315-10 G1/2: 4315-11 G3/4: 4315-12 3/8 PTF: 4315-02 1/2 PTF: 4315-03 3/4 PTF: 4315-04	G1/4: 4316-52 1/4 PTF: 4316-50	G 3/8: T74B-3GA-P1N G 1/2: T74B-4GA-P1N G 3/4: T74B-6GA-P1N	G 3/8: T74T-3GA-P1N G 1/2: T74T-4GA-P1N G 3/4: T74T-6GA-P1N 1/2 PTF: T74T-4AA-P1N 3/4 PTF: T74T-6AA-P1N

\*1) Please use a Quikmount pipe adaptor if the Quikclamp be mounted at inlet or outlet side.

**Pressure switch**

Porting block for pressure switch



Page 4

0523110000000000

Pressure switch (0,5 ... 8 bar)



0881300000000000

**Padlock**

Padlock (brass) with two keys \*1)

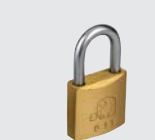

0613633000000000

\*1) for shut-off valves

**Service kits**

Manual drain



F74H-KITM0C

F74C-KITM0C

Automatic drain



F74H-KITA0C

F74C-KITA0C

Replacement element



4344-02

4344-01

**Drawings**  
**F74C**

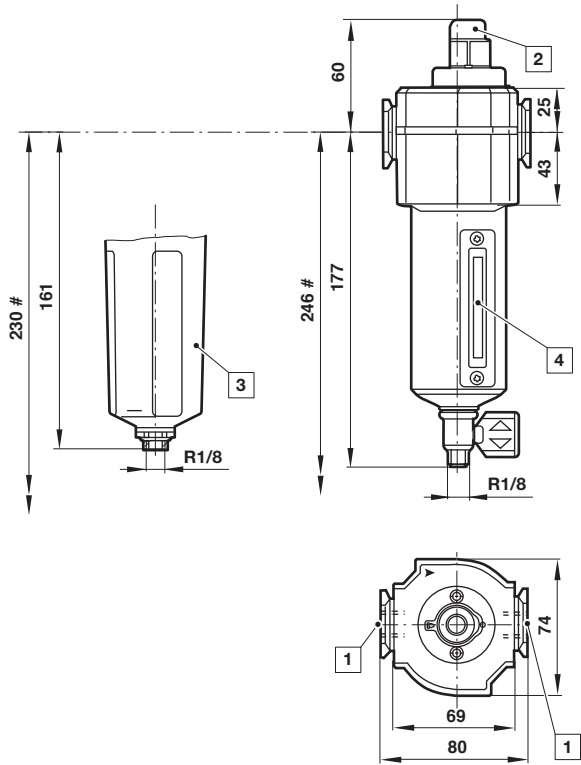

**F74H**

Dimensions in mm  
Projection/First angle

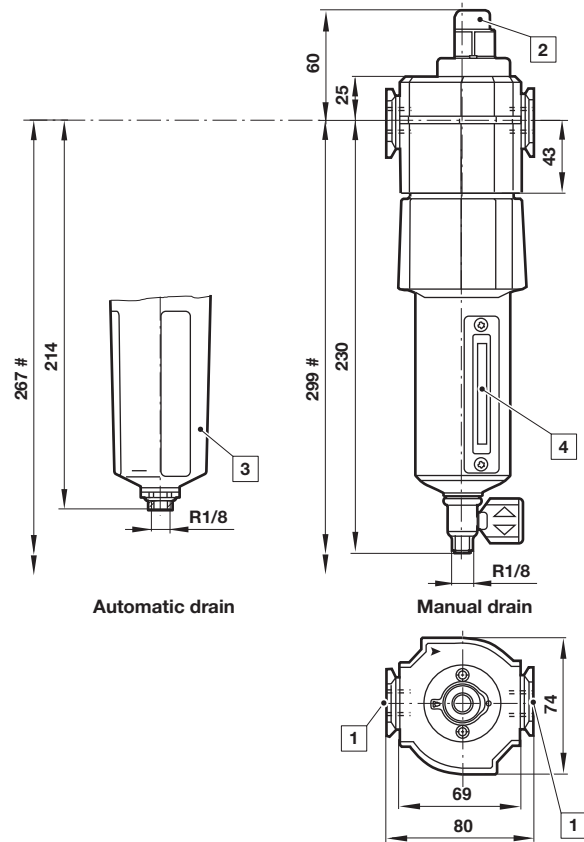

# Minimum clearance required to remove bowl

- 1 Main ports 3/8", 1/2" or 3/4"
- 2 Service life indicator
- 3 Transparent bowl with guard
- 4 Metal bowl with liquid level indicator lens

**Accessories**  
**Quikclamp®**

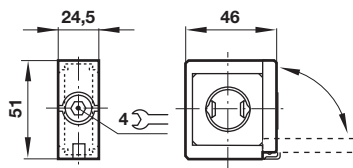

**Quikclamp® with wall bracket**

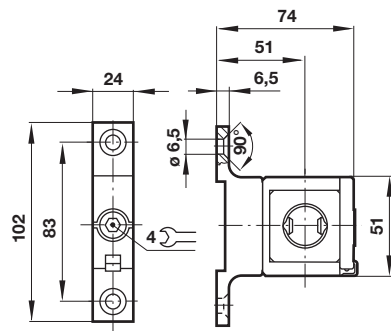

**Porting block**

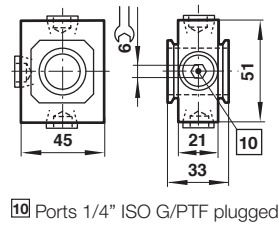

**Pipe adapter**

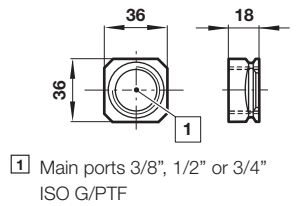

1 Main ports 3/8", 1/2" or 3/4" ISO G/PTF

10 Ports 1/4" ISO G/PTF plugged

### Wall mounting bracket

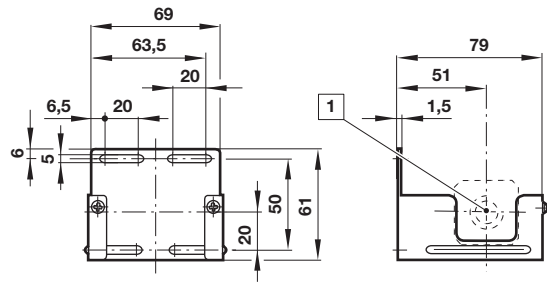

1 Main ports

### Shut-off valves

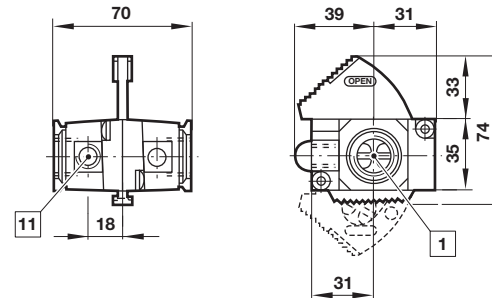

1 Main ports 3/8", 1/2" or 3/4" ISO G/PTF  
11 Exhaust port 1/8"

Dimensions in mm  
Projection/First angle



### Porting block for pressure switch

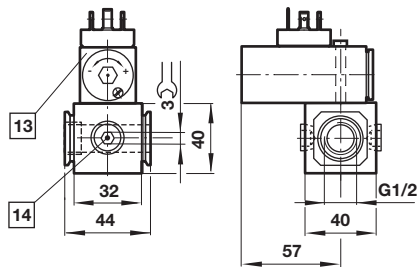

13 Pressure switch is not in scope of delivery  
14 Alternative G1/4 ports plugged

### Warning

These products are intended for use in industrial compressed air systems only. Do not use these products where pressures and temperatures can exceed those listed under

#### »Technical features/data«.

Before using these products with fluids other than those specified, for non-industrial applications, life-support systems or other applications not within published specifications, consult IMI Precision Engineering, Norgren Inc. Through misuse, age, or malfunction, components used in fluid power systems can fail in various modes.

The system designer is warned to consider the failure modes of all component parts used in fluid power systems and to provide adequate safeguards to prevent personal injury or damage to equipment in the event of such failure.

System designers must provide a warning to end users in the system instructional manual if protection against a failure mode cannot be adequately provided.

System designers and end users are cautioned to review specific warnings found in instruction sheets packed and shipped with these products.